

Capestone
For
Urbex

IMPORTANT NOTES:
(These notes are an integral part of this plan)
This plan was prepared to support a Reconfiguration of Lot application for the land situated at Mango Hill. The Contours, boundaries, creek line, flood lines, building locations have all been scaled and should not have any reliance based on them as they are only intended as a general guide. The configuration of allotments shown on this plan is subject to Local Authority (and relevant State Government Authority) approvals, detailed design, final survey, and registration of survey plans. Any comments contained on this plan should be confirmed by the relevant authorities. The dimensions, areas and total number of lots shown hereon are subject to field survey and also to the requirements of Council and any other authority which may have requirements under any relevant legislation. In particular, no reliance should be placed on the information on this plan for any financial dealings involving the land.

Copyright © Veris Australia Pty Ltd. August 2018

THESE DESIGNS AND DRAWINGS ARE COPYRIGHT AND ARE NOT TO BE USED OR REPRODUCED WITHOUT THE WRITTEN PERMISSION OF VERIS

Data Sources
Cadastral Boundaries 30105-BLE25-D.dwg

Issue	Revisions	Date	Drawn
E	Amend References/Lot 1873	02.08.2018	KS
D	Amend Layout/Lot Mix	11.12.2017	KS
C	Amended Stage boundaries	31.08.2017	KS/SI
B	Amended Road layout	14.06.2017	KS/SI
A	Original	23.02.2017	KS/SI

Scale: 1:1,000@A2
Drawn: KS
Checked: KS
Plot Date: 02 Aug, 2018
Computer File Ref: 30105-BLE25-E.dwg

CAPESTONE
Stage 20A Building
Location Envelope
Plan for
Detached Product
Excluding lots 1843, 1849
& 1850



veris

BRISBANE (07) 3666 4700 WHITSUNDAYS (07) 4945 1722
MACKAY (07) 4951 2911 CAIRNS (07) 4051 6722

veris.com.au
ACN 615 735 727
Veris Australia Pty Ltd

Drawing No 30105-BLE25 Issue E

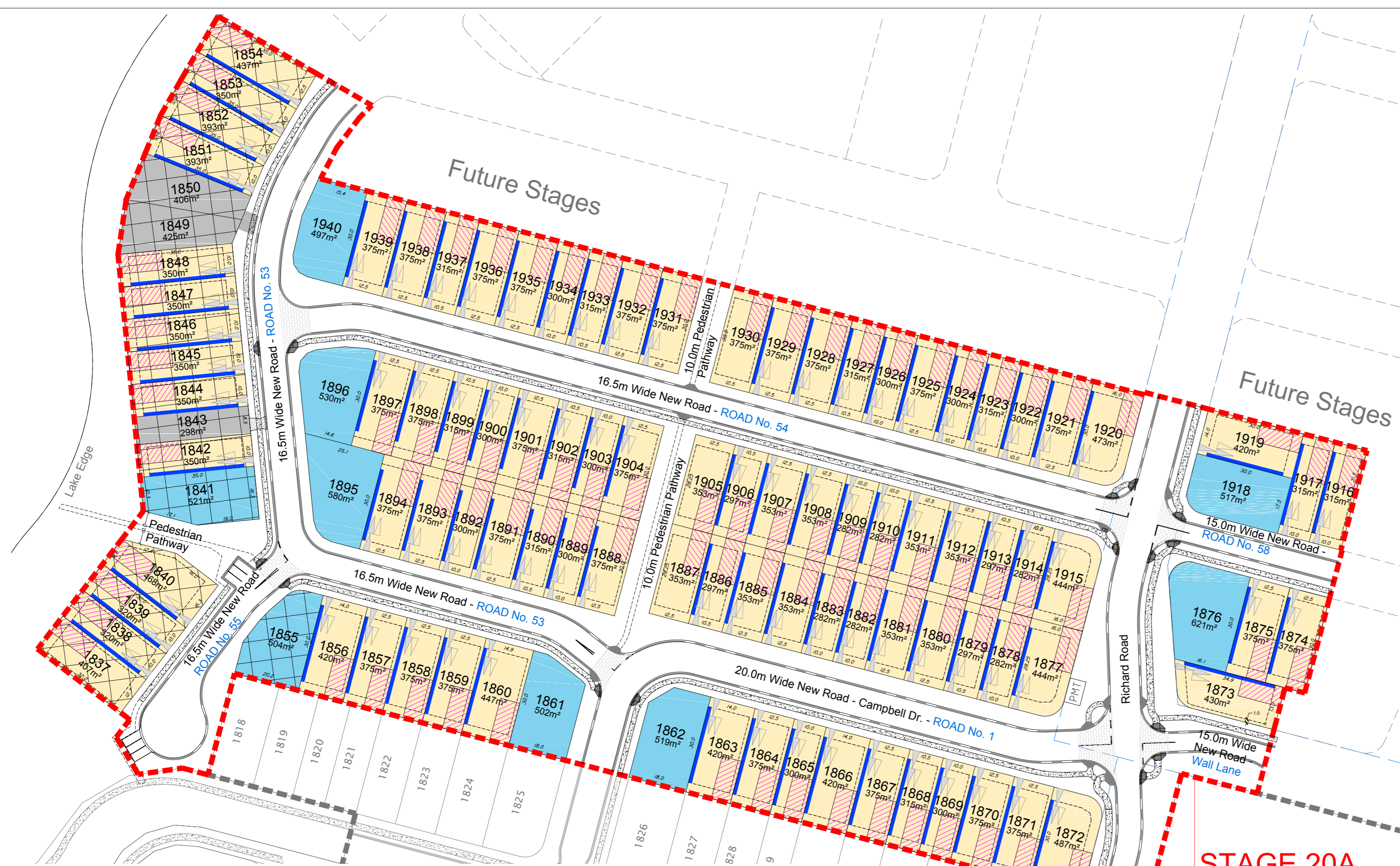

STAGE 20A

Notes applicable to Small Lots

- Small Lot Housing is to be undertaken in accordance with this Small Lot Plan and the Detached Houses on Small Residential Lots Code of the PineRiversPlan or the relevant code contained in the Development Permit that created these lots. Where a conflict exists between the approved small lot plan and the relevant code the small lot plan prevails.
- Built to the Boundary walls are optional where the road frontage widths are 12.5m or greater.
Where road frontages are less than 12.5m, Built to the Boundary walls are provided in the following manner:

	Single Garage (3.5m or less)	Double Garage (greater than 3.5m)
Single Storey	Optional	Mandatory
Two Storey	Optional	Optional
- Built to the Boundary walls shall be built with a maximum length of 15m and a maximum height of 3.5m.
- The private open space is:
 - at least 80m² in size;
 - all dimensions are greater than 2.5m;
 - able to fully contain a circle with a diameter of 5.0m;
 - not located in the front setback from primary frontage.
- The maximum height of buildings shall not exceed 2 storeys.
- Dwellings must address the street with a minimum of a front door and habitable room window facing the street.
- Minimum Road frontage boundary setbacks shall be as per the following setbacks table, unless otherwise dimensioned:

Typical Av. Lot Width (m)	First Storey Side Setback (m) to wall	First Storey Side Setback (m) to eave	Second Storey Side Setback (m) to wall	Second Storey Side Setback (m) to eave
10 to 12.49	1.0	0.45	1.0	0.45
12.5 to 14.99	1.0	0.45	1.5	0.9
15 and above	1.5	0.9	2.0	1.4

	Walls	Eaves
Living & Habitable areas	3.0 m	2.4 m
Garages and Carports	5.4 m	4.8 m
Secondary Road Frontage	3.0 m	2.4 m

8. Minimum Side boundary setbacks (other than Built to the Boundary walls) shall be as per the following setback table, unless otherwise dimensioned or noted in an approved setbacks table:

Typical Av. Lot Width (m)	First Storey Side Setback (m) to wall	First Storey Side Setback (m) to eave	Second Storey Side Setback (m) to wall	Second Storey Side Setback (m) to eave
10 to 12.49	1.0	0.45	1.0	0.45
12.5 to 14.99	1.0	0.45	1.5	0.9
15 and above	1.5	0.9	2.0	1.4

9. Minimum Rear boundary setbacks shall be as per the following setback table:

	Walls	Eaves
Ground Floor	3.0 m	2.4 m
First Floor	3.0 m	1.4 m

Rear patios may be located closer to the rear property boundary than stated, provided that the patio is located not less than 1.5m from the rear property boundary and the patio remains open and not enclosed.

10. Maximum Site Coverage is 50% plus 10% for open framed elements such as patios and alfresco areas.

Legend

Stage Boundary	
Pathway	
Mandatory 2 Storey Detached Product for Lots 1837-1854 & 1855	
Existing Lot boundary	
Mandatory Shared Driveways Locations.	
Driveway design must be in accordance with Council requirements.	
Driveways Locations	
Driveway design must be in accordance with Council requirements.	

BLE Legend

Mandatory Driveway Location	
Maximum Building Location Envelope (BLE)	
Built to Boundary line (maximum 15.0m in length)	
Possible Open Space Location	
Refer to Plan 30105-BLE25-E & 30105-GP50-E for Setback & Development Requirements	
Refer to Plan 30105-BLE26-E (Sheet 1 & 2) for Setback & Development Requirements	

