



I, Peter Sippel being a cadastral surveyor and duly authorised representative of THG WSG Pty Ltd hereby:

- certify the information contained in this drawing is an accurate as constructed representation of the works
- accept responsibility for the as constructed information contained in this drawing
- acknowledge the as constructed information contained in the drawing may be relied on by council and others

Certification of Stage 6 by [Signature] on 12/3/15
(Signature) (Date)
for THG WSG Pty Ltd

ENGINEER'S CERTIFICATION

"I, David Polden being a Consulting Engineer and duly authorised representative of: - BMD Consulting hereby:-

- certify the information contained in this drawing is an accurate "as constructed" representation of the works;
- accept responsibility for the "as constructed" information contained in this drawing; and
- acknowledge the "as constructed" information contained in the drawing may be relied on by the Moreton Bay Regional Council and others.

Certification for Stage 6 by [Signature] on 10.04.15
For: BMD CONSULTING Pty. Ltd. RPEQ 1907

- LEGEND**
- New Hydrant
 - New Valve
 - New End Cap
 - New Water Service Conduit (Indicative Only)
 - New Water Service point of entry (Indicative Only)
 - New Water House connection (Indicative Only)

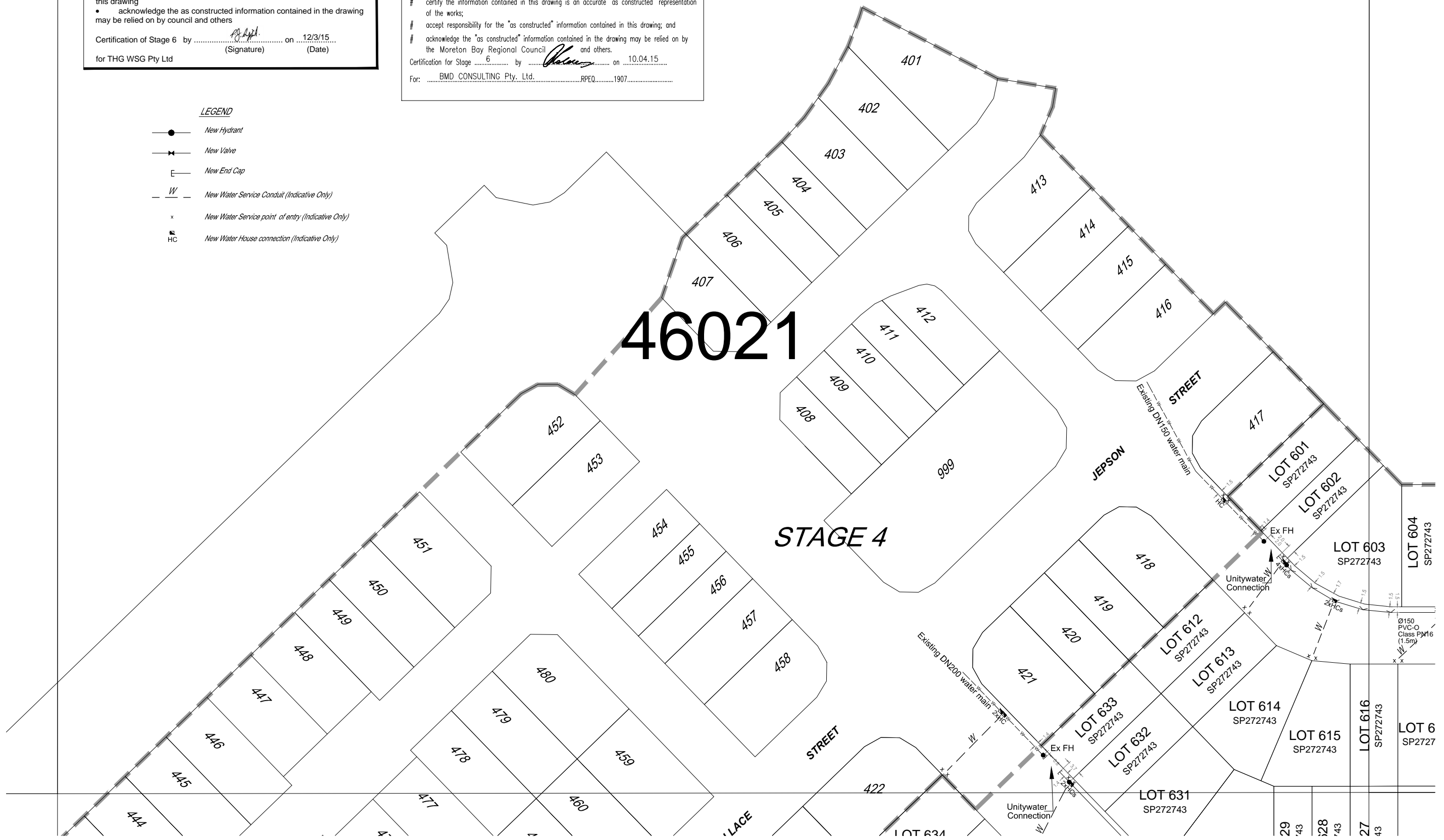

DRAWING REVISIONS		REFERENCE DRAWINGS		DESIGN FILE No.	DESIGNED	<p>THIS WORK WAS PREPARED BY: THG WSG PTY LTD</p> <p>SCALE 1:500 ORIGINAL SIZE A1</p>	<p>MORETON BAY REGIONAL COUNCIL CABOOLTURE DISTRICT OFFICE 2 HASKING STREET CABOOLTURE QLD 4510 PO BOX 159 CABOOLTURE QLD 4510 Telephone: (07) 5433 0100 Fax: (07) 5433 4000</p>	<p>STAGE 6, CAPESTONE AS CONSTRUCTED WATER RETICULATION</p>	MBRC SUBDIVISION REFERENCE		
REV.	REVISION DESCRIPTION	DRG. No.	DESCRIPTION	CONSTRUCT. No.	DATE				DA/29021/2014/V23R	No. 1 OF 4 PLANS	
A	Original			247406_6 AW	DRAWN EJM				ASCON GRID NUMBER		REV.
B	Update				DATE 12/3/15				46021		C
C	Update HCs				CHECKED EJM						
				LOG BOOK	DATE 12/3/15						
				LEVEL DATUM	AHD						
				DATUM	PM137449						



ENGINEER'S CERTIFICATION
 I, David Polden
 being a Consulting Engineer and duly authorised representative of: -
 BMD Consulting
 hereby:-
 # certify the information contained in this drawing is an accurate "as constructed" representation of the works;
 # accept responsibility for the "as constructed" information contained in this drawing; and
 # acknowledge the "as constructed" information contained in the drawing may be relied on by the Moreton Bay Regional Council and others.
 Certification for Stage 6 by [Signature] on 10.04.15
 For: BMD CONSULTING Pty. Ltd. RPEQ. 1907.

I, Peter Sippel being a cadastral surveyor and duly authorised representative of THG WSG Pty Ltd hereby:
 • certify the information contained in this drawing is an accurate as constructed representation of the works
 • accept responsibility for the as constructed information contained in this drawing
 • acknowledge the as constructed information contained in the drawing may be relied on by council and others
 Certification of Stage 6 by [Signature] on 12/3/15
 for THG WSG Pty Ltd (Signature) (Date)

LEGEND

- New Hydrant
- ✕ New Valve
- New End Cap
- W — New Water Service Conduit (Indicative Only)
- x New Water Service point of entry (Indicative Only)
- HC New Water House connection (Indicative Only)

46022

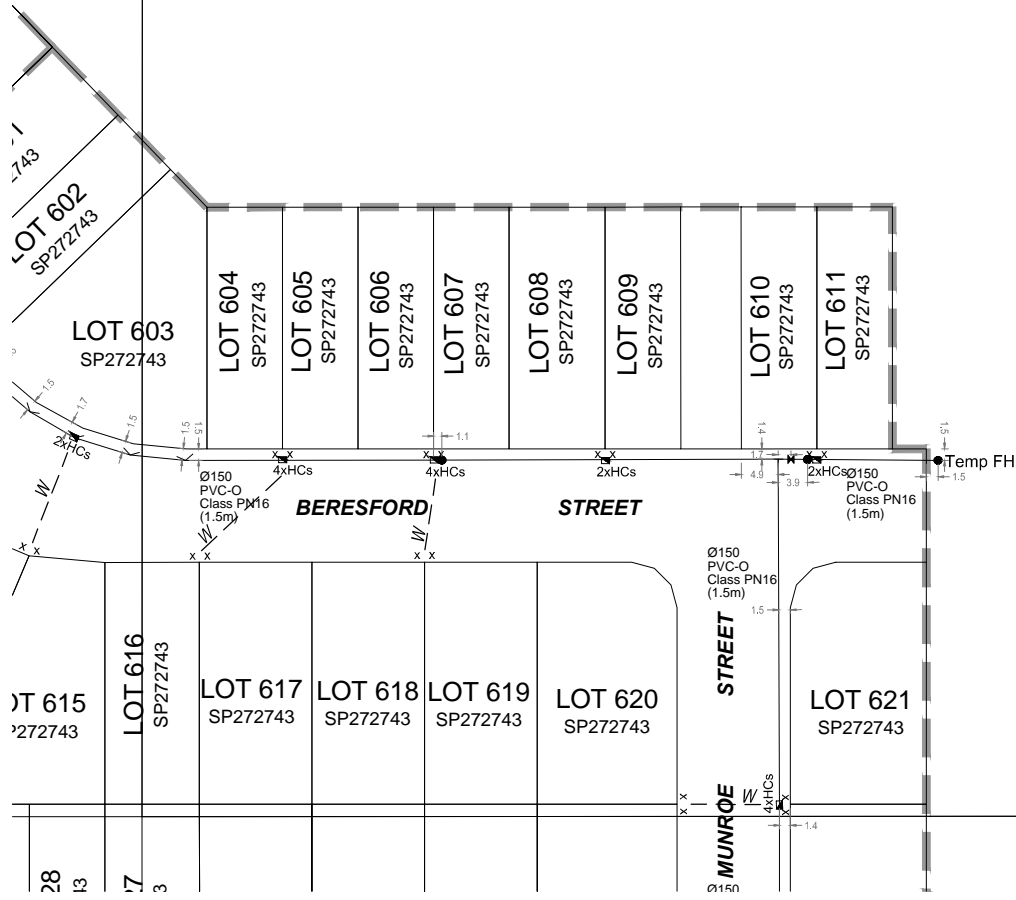

DRAWING REVISIONS		REFERENCE DRAWINGS		DESIGN FILE No.	DESIGNED
REV.	REVISION DESCRIPTION	DRG. No.	DESCRIPTION	CONSTRUCT. No.	DATE
A	Original			247406_6 AW	EJM
B	Update			FIELD BOOK	12/3/15
C	Update HCs			LOG BOOK	EJM
				LEVEL DATUM	AHD
				DATUM	PM137449

THIS WORK WAS PREPARED BY:
THG WSG PTY LTD

SCALE 1:500 ORIGINAL SIZE A1

MORETON BAY REGIONAL COUNCIL
 CABOOLTURE DISTRICT OFFICE
 2 HASKING STREET CABOOLTURE QLD 4510
 Telephone: (07) 5433 0100
 Fax: (07) 5433 4000

STAGE 6, CAPESTONE AS CONSTRUCTED WATER RETICULATION

MBRC SUBDIVISION REFERENCE	
DA/29021/2014/V23R	
No. 2 OF 4 PLANS	
ASCAN GRID NUMBER	REV.
46022	C



46188 STAGE 5

ENGINEER'S CERTIFICATION

I, David Polden, being a Consulting Engineer and duly authorised representative of: - BMD Consulting hereby:-

- certify the information contained in this drawing is an accurate "as constructed" representation of the works;
- accept responsibility for the "as constructed" information contained in this drawing; and
- acknowledge the "as constructed" information contained in the drawing may be relied on by the Moreton Bay Regional Council and others.

Certification for Stage 6 by [Signature] on 10.04.15

For: BMD CONSULTING Pty. Ltd. RPEQ 1907

I, Peter Sippel, being a cadastral surveyor and duly authorised representative of THG WSG Pty Ltd hereby:

- certify the information contained in this drawing is an accurate as constructed representation of the works
- accept responsibility for the as constructed information contained in this drawing
- acknowledge the as constructed information contained in the drawing may be relied on by council and others

Certification of Stage 6 by [Signature] on 12/3/15

for THG WSG Pty Ltd (Signature) (Date)

- LEGEND**
- New Hydrant
 - ✕ New Valve
 - New End Cap
 - W — New Water Service Conduit (Indicative Only)
 - x New Water Service point of entry (Indicative Only)
 - HC New Water House connection (Indicative Only)

DRAWING REVISIONS		REFERENCE DRAWINGS		DESIGN FILE No.	DESIGNED
REV.	REVISION DESCRIPTION	DRG. No.	DESCRIPTION	CONSTRUCT. No.	DATE
A	Original			247406_6 AW	EJM
B	Update			FIELD BOOK	DATE 12/3/15
C	Update HCs			LOG BOOK	CHECKED EJM
				LEVEL DATUM	DATE 12/3/15
				DATUM	PM137449

THIS WORK WAS PREPARED BY:
THG WSG PTY LTD

SCALE 1:500 ORIGINAL SIZE A1



MORETON BAY REGIONAL COUNCIL
 CABOOLTURE DISTRICT OFFICE
 2 HASKING STREET CABOOLTURE QLD 4510
 PO BOX 159 CABOOLTURE QLD 4510
 Telephone: (07) 5433 0100
 Fax: (07) 5433 4000

STAGE 6, CAPESTONE AS CONSTRUCTED WATER RETICULATION

MBRC SUBDIVISION REFERENCE	
DA/29021/2014/V23R	
No. 3 OF 4 PLANS	
ASCAN GRID NUMBER	REV.
46188	C

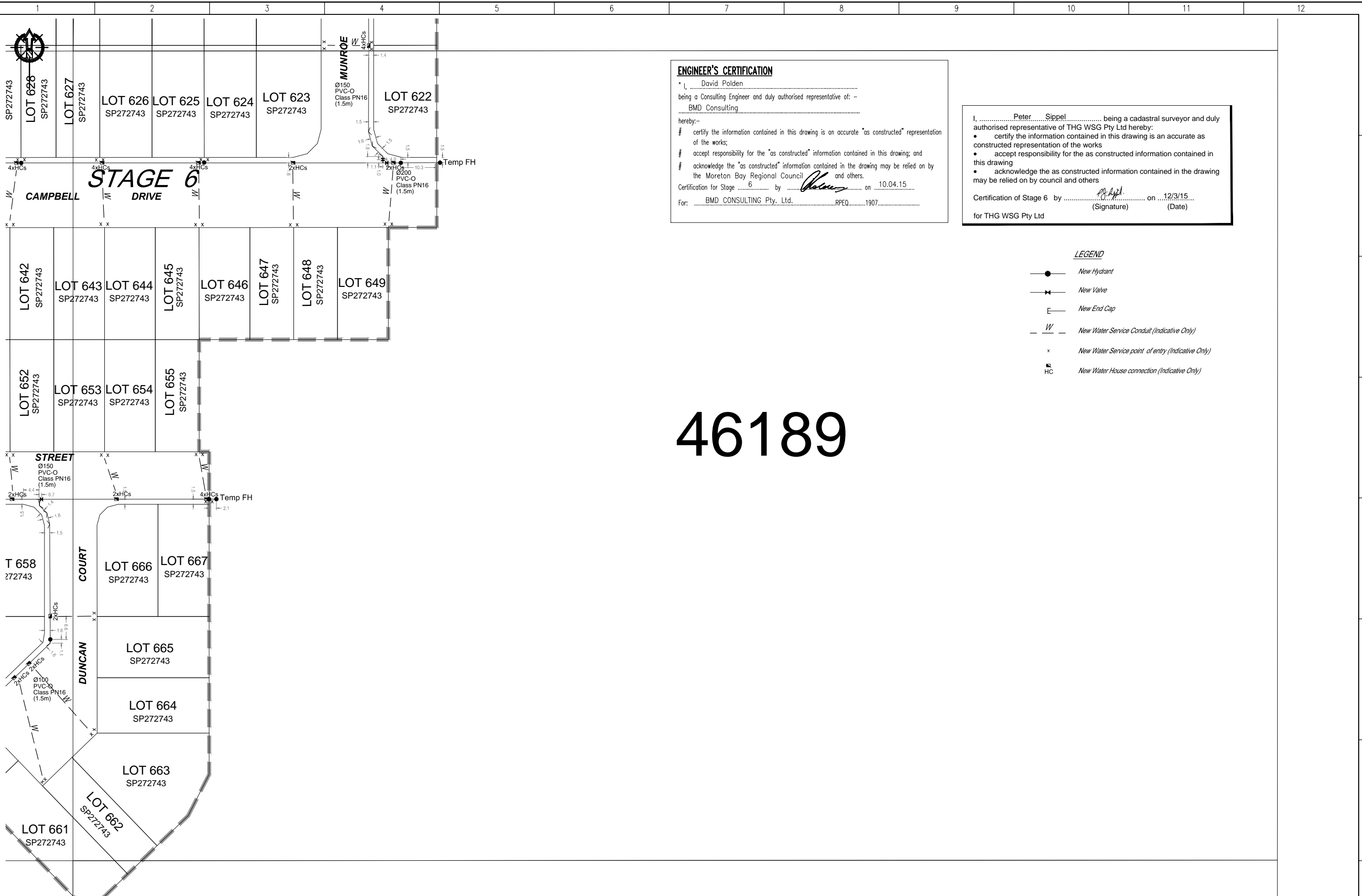

ENGINEER'S CERTIFICATION
 I, David Palden
 being a Consulting Engineer and duly authorised representative of -
 BMD Consulting
 hereby:-
 # certify the information contained in this drawing is an accurate "as constructed" representation of the works;
 # accept responsibility for the "as constructed" information contained in this drawing; and
 # acknowledge the "as constructed" information contained in the drawing may be relied on by the Moreton Bay Regional Council and others.
 Certification for Stage 6 by [Signature] on 10.04.15
 For: BMD CONSULTING Pty. Ltd. RPEQ. 1907

I, Peter Sippel being a cadastral surveyor and duly authorised representative of THG WSG Pty Ltd hereby:
 • certify the information contained in this drawing is an accurate as constructed representation of the works
 • accept responsibility for the as constructed information contained in this drawing
 • acknowledge the as constructed information contained in the drawing may be relied on by council and others
 Certification of Stage 6 by [Signature] on 12/3/15
 (Signature) (Date)
 for THG WSG Pty Ltd

- LEGEND**
- New Hydrant
 - ✕ New Valve
 - ┌ New End Cap
 - W — New Water Service Conduit (Indicative Only)
 - x New Water Service point of entry (Indicative Only)
 - HC New Water House connection (Indicative Only)

46189

DRAWING REVISIONS		REFERENCE DRAWINGS		DESIGN FILE No.	DESIGNED
REV.	REVISION DESCRIPTION	DRG. No.	DESCRIPTION	CONSTRUCT. No.	DATE
A	Original			247406_6 AW	EJM
B	Update			FIELD BOOK	DATE 12/3/15
C	Update HCs			LOG BOOK	CHECKED EJM
				LEVEL DATUM	DATE 12/3/15
				DATUM	PM137449

THIS WORK WAS PREPARED BY:
THG WSG PTY LTD

SCALE 1:500 ORIGINAL SIZE A1

MORETON BAY REGIONAL COUNCIL
 CABOOLTURE DISTRICT OFFICE
 2 HASKING STREET CABOOLTURE QLD 4510
 PO BOX 159 CABOOLTURE QLD 4510
 Telephone: (07) 5433 0100
 Fax: (07) 5433 4000

STAGE 6, CAPESTONE AS CONSTRUCTED WATER RETICULATION

MBRC SUBDIVISION REFERENCE	
DA/29021/2014/V23R	
No. 4 OF 4 PLANS	
ASCAN GRID NUMBER	REV.
46189	C