

946
S312890

ENGINEER'S CERTIFICATION
 I, DARRYL HAYTER
 being a Consulting Engineer and duly authorised representative of: -
 EMPOWER ENGINEERS AND PROJECT MANAGERS
 hereby:-
 # certify the information contained in this drawing is an accurate "as constructed" representation of the works;
 # accept responsibility for the "as constructed" information contained in this drawing; and
 # acknowledge the "as constructed" information contained in the drawing may be relied on by the Moreton Bay Regional Council and others.
 Certification for Stage 14 by *D.H.* on 22/08/17
 For: EMPOWER ENGINEERS AND PROJECT MANAGERS RPEQ 5694

I, Peter Sippel being a cadastral surveyor and duly authorised representative of Queensland Surveying Pty Ltd hereby:
 • certify the information contained in this drawing is an accurate as constructed representation of the works
 • accept responsibility for the as constructed information contained in this drawing
 • acknowledge the as constructed information contained in the drawing may be relied on by council and others
 Certification by *P.S.* on 8/8/2017
 (Signature) (Date)
 for Queensland Surveying Pty Ltd

DRAWING REVISIONS		REFERENCE DRAWINGS		DESIGN FILE No.	DESIGNED
REV.	REVISION DESCRIPTION	DRG. No.	DESCRIPTION	CONSTRUCT. No.	DATE
A	Progress Plot				EJM 8/8/17
B	Update				EJM 8/8/17

FIELD BOOK	LOG BOOK	LEVEL DATUM	DATUM
		AHD	PM177891

THIS WORK WAS PREPARED BY:
QUEENSLAND SURVEYING PTY LTD
 SCALE 1:500 ORIGINAL SIZE A1



MORETON BAY REGIONAL COUNCIL
 CABOOLTURE DISTRICT OFFICE
 2 HASKING STREET CABOOLTURE QLD 4510
 Telephone: (07) 5433 0100
 Fax: (07) 5433 4000

STAGE 14, CAPESTONE AS CONSTRUCTED DRAINAGE		MBRC SUBDIVISION REFERENCE	
		DA/31223/2016/V23R	
		No. 1 OF 2 PLANS	
		DRAWING NUMBER	REV.
		30105-140100 AD	B

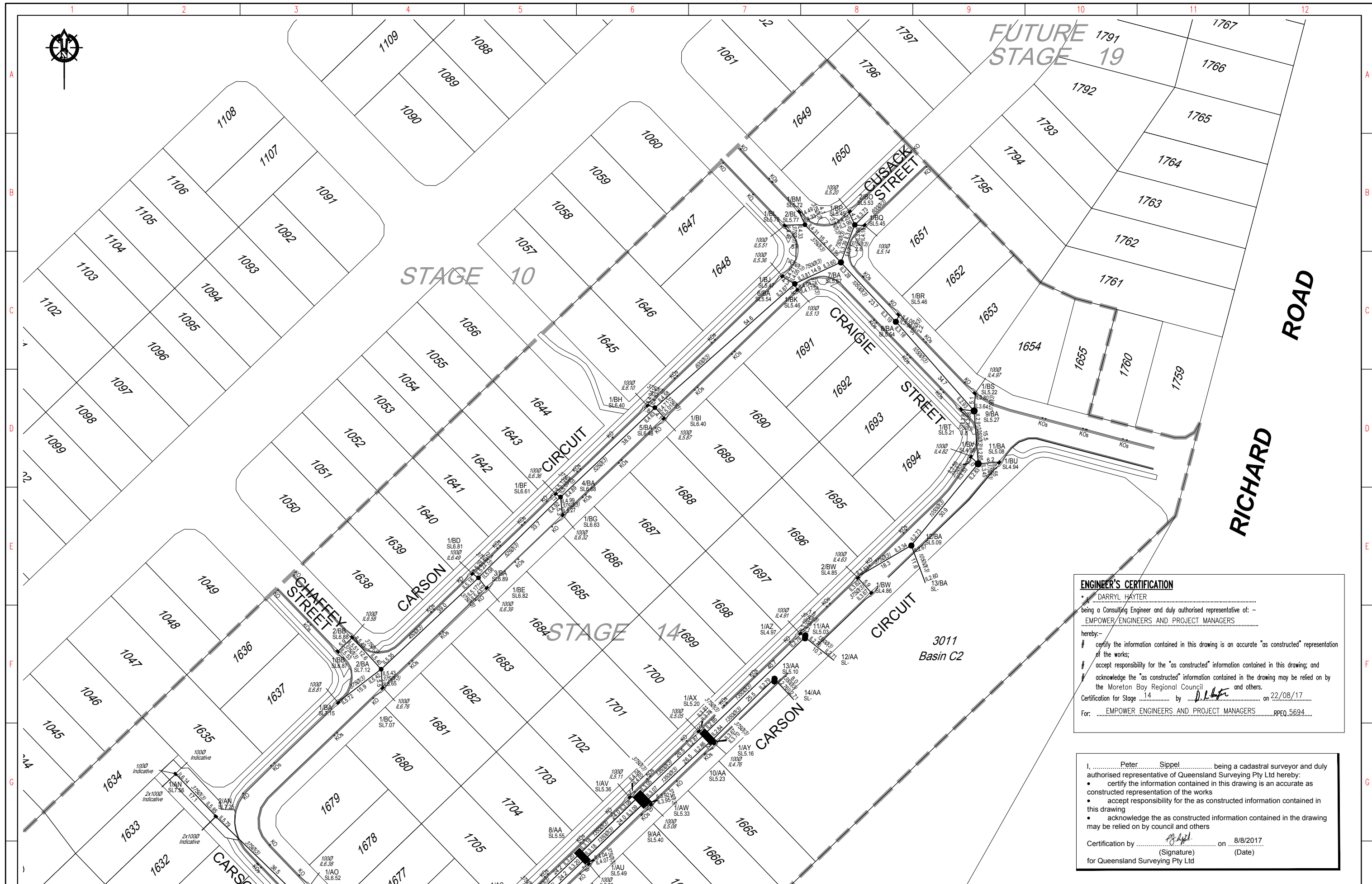

ENGINEER'S CERTIFICATION
 DARRYL HAYTER
 being a Consulting Engineer and duly authorised representative of: -
 EMPOWER ENGINEERS AND PROJECT MANAGERS
 hereby:-
 # certify the information contained in this drawing is an accurate "as constructed" representation of the works;
 # accept responsibility for the "as constructed" information contained in this drawing; and
 # acknowledge the "as constructed" information contained in the drawing may be relied on by the Moreton Bay Regional Council and others.
 Certification for Stage 14 by *D.H.* on 22/08/17
 For: EMPOWER ENGINEERS AND PROJECT MANAGERS RPE05694

I, Peter Sippe, being a cadastral surveyor and duly authorised representative of Queensland Surveying Pty Ltd hereby:
 • certify the information contained in this drawing is an accurate as constructed representation of the works
 • accept responsibility for the as constructed information contained in this drawing
 • acknowledge the as constructed information contained in the drawing may be relied on by council and others
 Certification by *P. Sippe* on 8/8/2017
 (Signature) (Date)
 for Queensland Surveying Pty Ltd

DRAWING REVISIONS		REFERENCE DRAWINGS		DESIGN FILE No.		DESIGNED	
REV.	REVISION DESCRIPTION	DRG. No.	DESCRIPTION	CONSTRUCT. No.	DATE	DATE	DATE
A	Progress Plot					8/8/17	EJM
B	Update					8/8/17	EJM

FIELD BOOK	AHD	DATE	8/8/17
LOG BOOK		CHECKED	EJM
LEVEL DATUM	PM177891	DATE	8/8/17
DATUM			

THIS WORK WAS PREPARED BY:
QUEENSLAND SURVEYING PTY LTD
 SCALE 1:500 ORIGINAL SIZE A1

MORETON BAY REGIONAL COUNCIL
 CABOOLTURE DISTRICT OFFICE
 2 HASKING STREET CABOOLTURE QLD 4510
 Telephone: (07) 5433 0100
 Fax: (07) 5433 4000

STAGE 14, CAPESTONE
AS CONSTRUCTED
DRAINAGE

MBRC SUBDIVISION REFERENCE	
DA/31223/2016/V23R	
No. 2 OF 2 PLANS	
DRAWING NUMBER	REV.
30105-140100 AD	B